

1: View over Cornelius Pass Rd Northbound

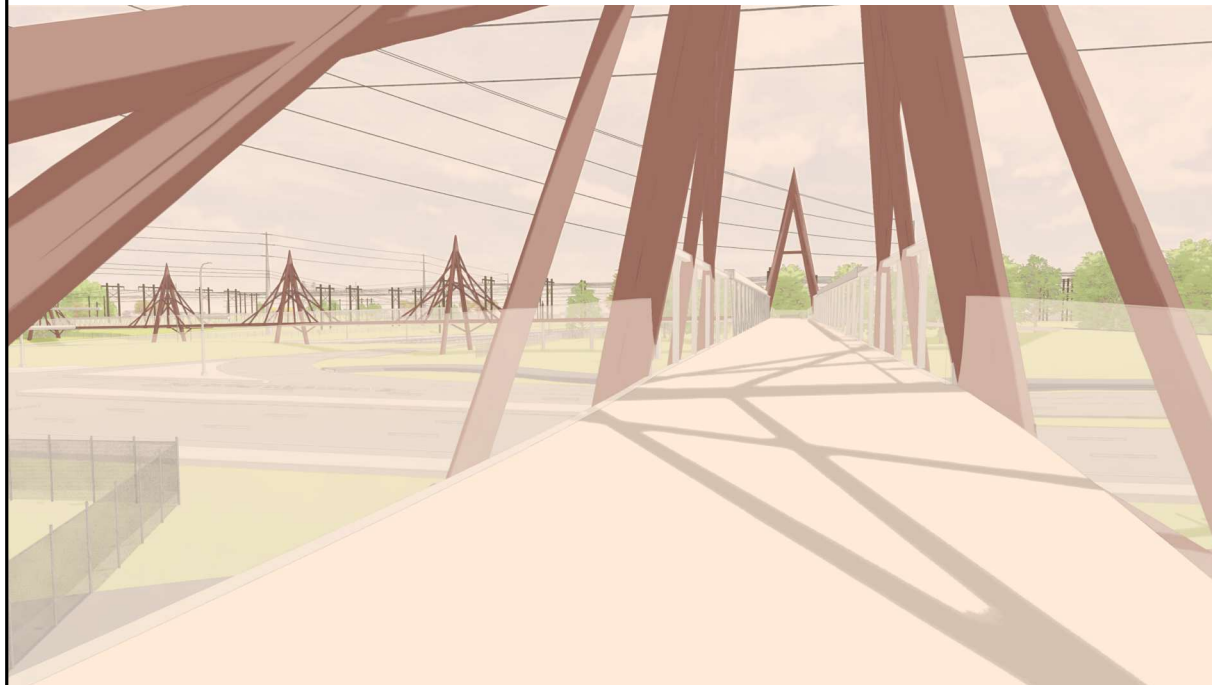

3: Driver's Perspective on US26 Westbound



2: On-Bridge View Approaching CPR Crossing Eastbound

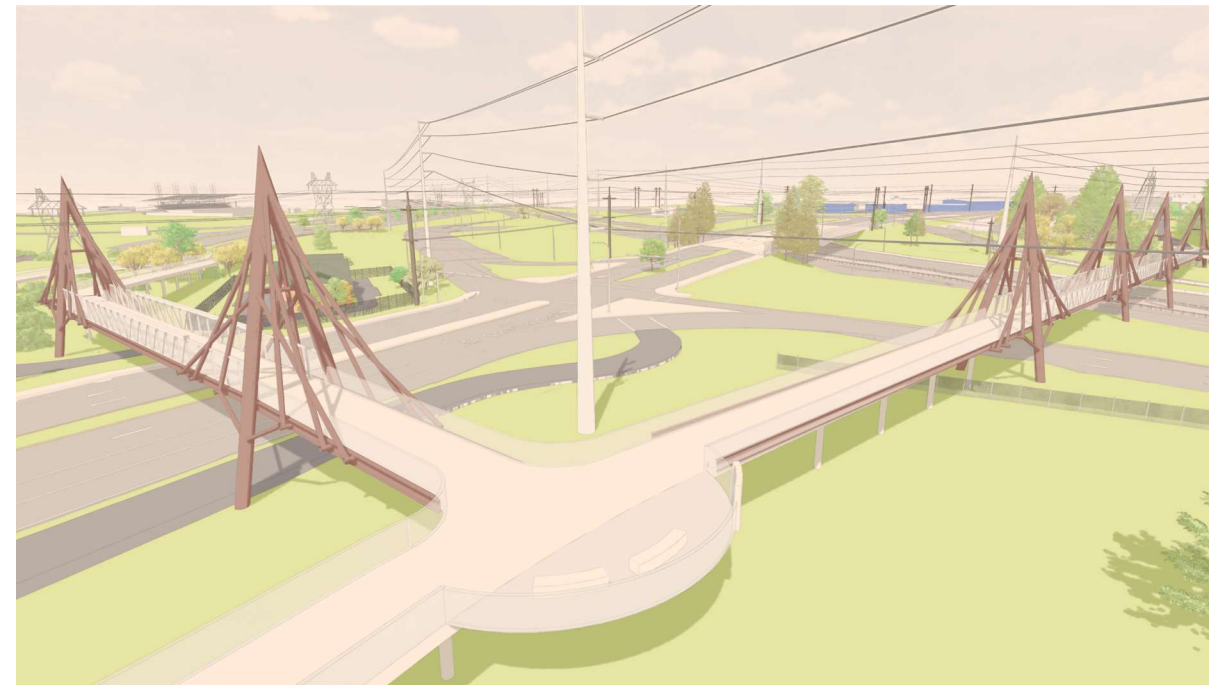

4: Aerial View Looking Northwest at Trail Intersection

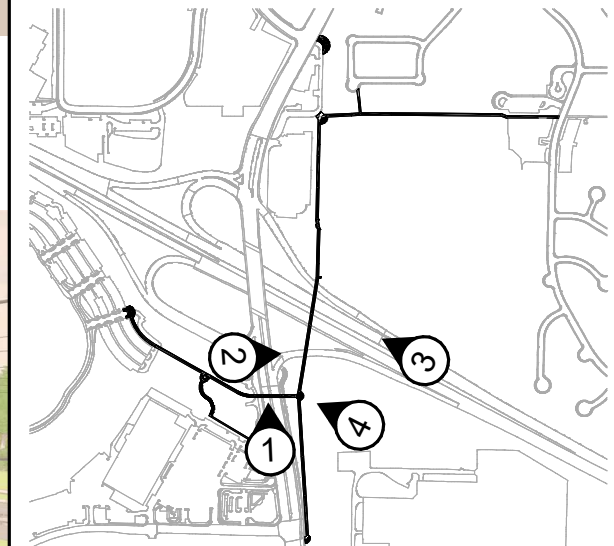

**BRIDGE OPT. 4 -  
CANTILEVER  
TOWERS**

**4.0**

Note: Bridge elements shown for overall shape and proportions. Connecting ramps, railings, and supporting bents are placeholders. Materials, colors and connection details will be determined in future design phases.

**OPTION 4 - CANTILEVER TOWERS**

A series of tall cantilevered towers support a continuous ribbon of structural girders and shallow trusses floating over the roadways. The towers are a contemporary play on the trussed utility transmission towers found around the site, with weight and visual presence to create a landmark emphasizing this key intersection in the Regional Trails network.

Scale:

2/17/2026

BRIDGE OPTIONS