

**US26 at CORNELIUS PASS
ROAD BICYCLE &
PEDESTRIAN CROSSING**
Hillsboro, Oregon

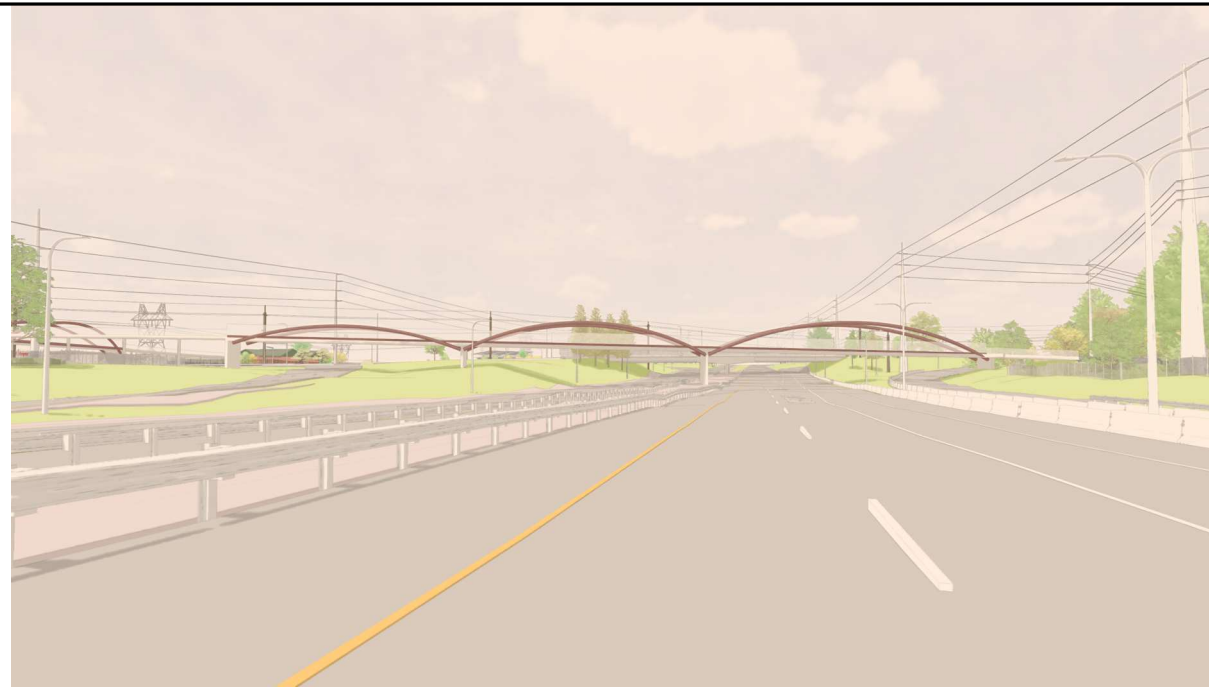

1: View over Cornelius Pass Rd Northbound



3: Driver's Perspective on US26 Westbound

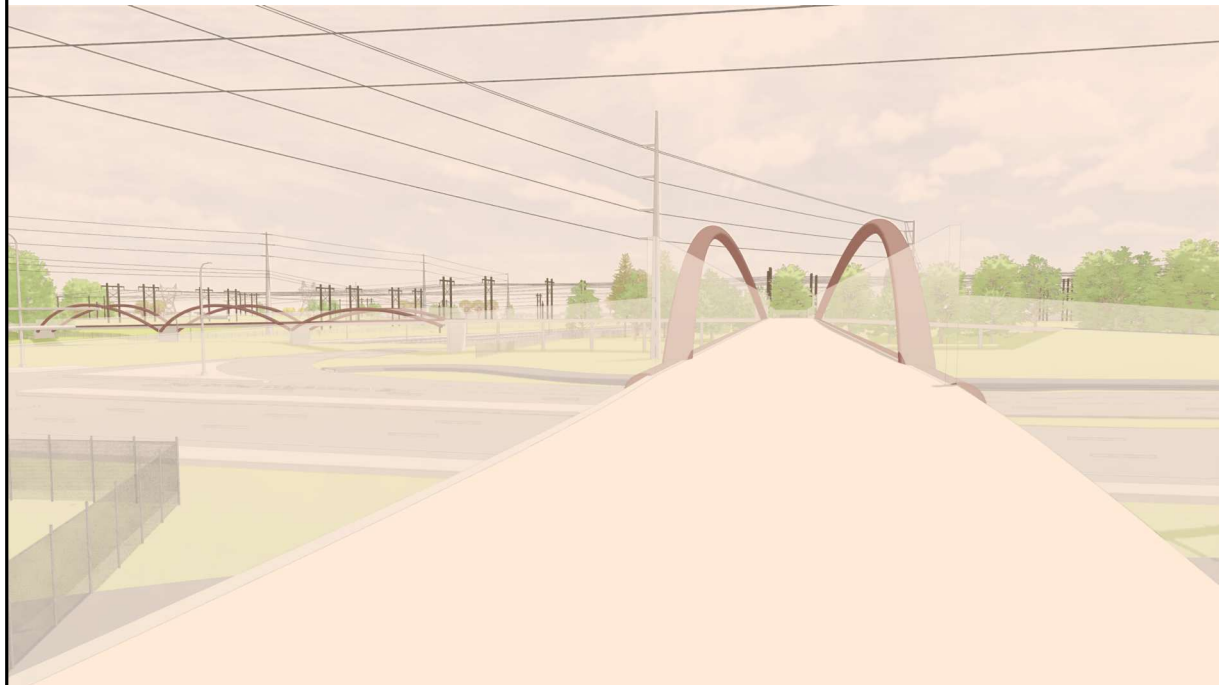

2: On-Bridge View Approaching CPR Crossing Eastbound

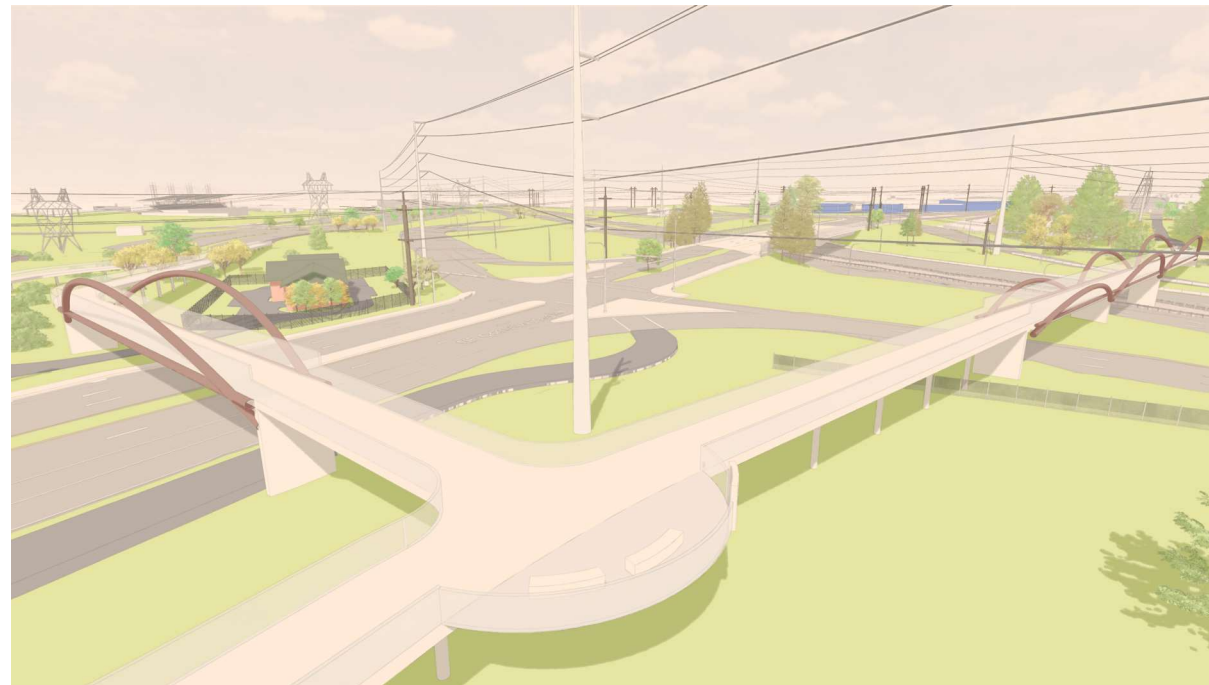

4: Aerial View Looking Northwest at Trail Intersection

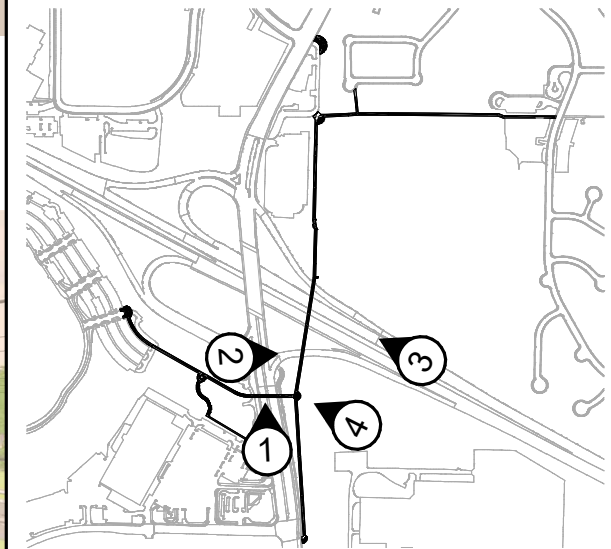

**BRIDGE OPT. 3 -
SPLAYED
ARCHES**

3.0

Note: Bridge elements shown for overall shape and proportions. Connecting ramps, railings, and supporting bents are placeholders. Materials, colors and connection details will be determined in future design phases.

OPTION 3 - SPLAYED ARCHES

Shallow, outward-splayed arches skip across the roadways with a strong horizontal form. This option prioritizes an expansive on-bridge experience, fully open to the sky and creating the perception of a wider bridge. The design references the rolling West Hills and Coast Range visible from the bridge, as well as the historically agricultural valley in between.

Scale:

2/17/2026

BRIDGE OPTIONS